



**Parkland**<sup>™</sup>  
RETIREMENT LIVING  
FREDERICTON

**All-Inclusive Lifestyle**

Governor Hall



## Two Bedroom

Suite Number: 06, 215, 306, 315, 406, 415  
Square Feet: 817  
Dimensions\*: Living / Dining - 14'8" x 11'11" Bedroom - 12'3" x 12'1"

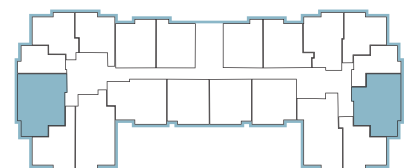

Floors 1-4

For more information about additional suites available at Parkland Fredericton contact our Lifestyle Consultant at 506-455-7275 or via [experienceparkland.com](http://experienceparkland.com).

*\*Suite measurements and features are approximate and may differ.*



**Parkland**<sup>™</sup>  
RETIREMENT LIVING  
FREDERICTON

**All-Inclusive Lifestyle**

Governor Hall



## Two Bedroom

Suite Number: 108, 208, 308, 408  
Square Feet: 836  
Dimensions\*: Living / Dining - 11'6" x 11'9" Bedroom - 10'6" x 14'10"

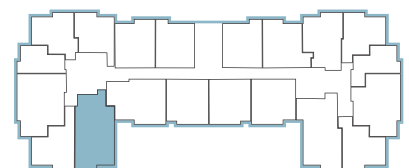

Floors 1-4

For more information about additional suites available at Parkland Fredericton contact our Lifestyle Consultant at 506-455-7275 or via [experienceparkland.com](http://experienceparkland.com).

*\*Suite measurements and features are approximate and may differ.*



**Parkland**<sup>™</sup>  
RETIREMENT LIVING  
FREDERICTON

**All-Inclusive Lifestyle**

Regent Hall



## Two Bedroom

Suite Number: 102, 114, 202, 214, 302, 314  
Square Feet: 1140  
Dimensions\*: Living Room - 13'6" x 13'3" Kitchen - 10'2" x 10'10"  
Bedrooms - 15'7" x 12'2" and 10' x 11'

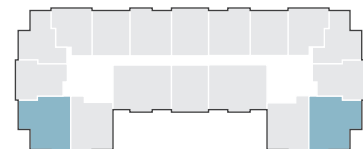

For more information about additional suites available at Parkland Fredericton contact our Lifestyle Consultant at 506-455-7275 or via [experienceparkland.com](http://experienceparkland.com).

\*Suite measurements and features are approximate and may differ.



**Parkland**<sup>™</sup>  
RETIREMENT LIVING  
FREDERICTON

**All-Inclusive Lifestyle**

Regent Hall



## Two Bedroom

Suite Number: 216, 218, 316, 318  
Square Feet: 1203  
Dimensions\*: Living Room - 12'11" x 14'8" Kitchen - 17'5" x 14'10"  
Bedrooms - 13'9" x 12'11" and 12'2" x 12'7"

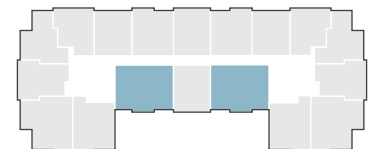

For more information about additional suites available at Parkland Fredericton contact our Lifestyle Consultant at 506-455-7275 or via [experienceparkland.com](http://experienceparkland.com).

\*Suite measurements and features are approximate and may differ.