



Parkland[™]
RETIREMENT LIVING
ANTIGONISH

All-Inclusive Lifestyle



One Bedroom

Suite Number: 304
Square Feet: 722
Dimensions*: Living / Dining - 15'2" x 24'10" Kitchen - 11'5" x 11'
Bedroom - 11'7" x 11'4"

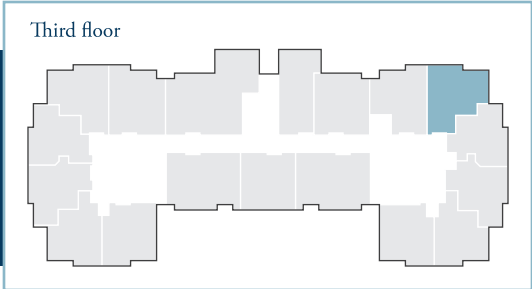

For more information about additional suites available at Parkland Antigonish contact our Lifestyle Consultant at 902-735-8900 or via experienceparkland.com.

* Suite measurements and features are approximate and may differ.



Parkland[™]
RETIREMENT LIVING
ANTIGONISH

All-Inclusive Lifestyle



One Bedroom

Suite Number: 307 and 313

Square Feet: 651

Dimensions*: Living / Dining - 12' x 12'2" Kitchen - 12' x 12'2"
Bedroom - 11'7" x 12'2"

Third floor

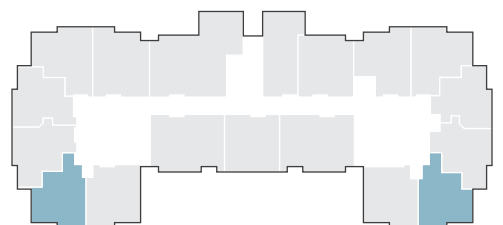

For more information about additional suites available at Parkland Antigonish contact our Lifestyle Consultant at 902-735-8900 or via experienceparkland.com.

**Suite measurements and features are approximate and may differ.*



Parkland[™]
RETIREMENT LIVING
ANTIGONISH

All-Inclusive Lifestyle



One Bedroom

Suite Number: 302
Square Feet: 707
Dimensions*: Living / Dining - 13' x 16'7" Kitchen - 13' x 9'6"
Bedroom - 11'3" x 16'

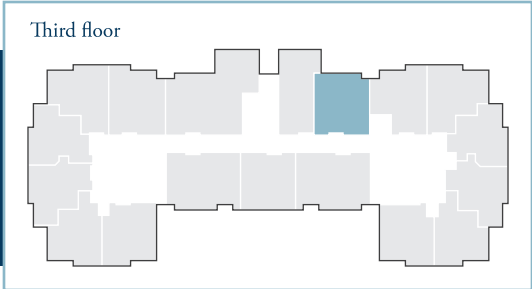

For more information about additional suites available at Parkland Antigonish contact our Lifestyle Consultant at 902-735-8900 or via experienceparkland.com.

*Suite measurements and features are approximate and may differ.



Parkland[™]
RETIREMENT LIVING
ANTIGONISH

All-Inclusive Lifestyle



One Bedroom

Suite Number: 310
Square Feet: 669
Dimensions*: Living / Dining - 12'11" x 15'1" Kitchen - 9'6" x 12'10"
Bedroom - 11'3" x 15'1"

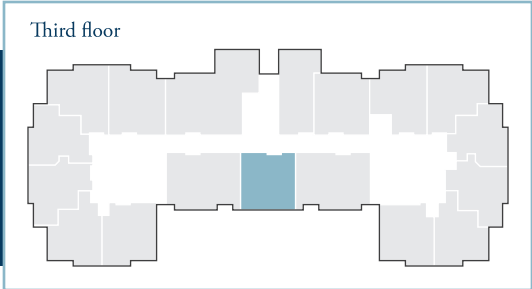

For more information about additional suites available at Parkland Antigonish contact our Lifestyle Consultant at 902-735-8900 or via experienceparkland.com.

**Suite measurements and features are approximate and may differ.*